

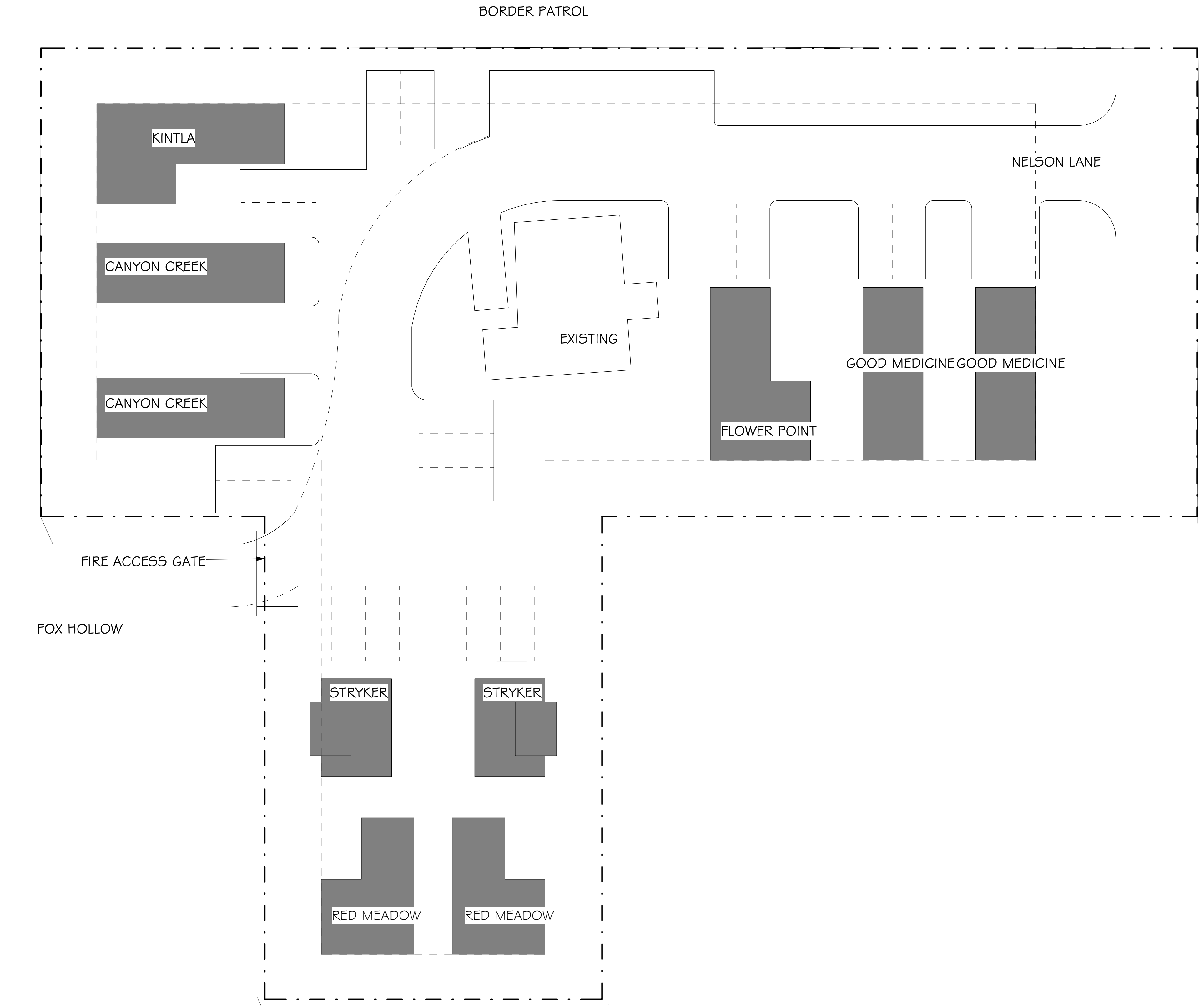

SITE LOCATION



1 ARCHITECTURAL SITE PLAN
A1.0 1/16" = 1'-0"

SITE PLAN

NOT FOR CONSTRUCTION

I hereby certify that this plan, specification or report was prepared by me or under my direct supervision and that I am a duly registered architect under the laws of the State of Montana, practicing in Whitefish, Montana.
 Reg. No. 12301 Date 9/18/2017
16-02A
 MATTHEW J. LAWRENCE

THESE PLANS AND SPECIFICATIONS ARE THE SOLE PROPERTY OF MONTANA CREATIVE ARCHITECTURE AND DESIGN. ANY REPRODUCTION OR REUSE OF THESE DOCUMENTS IS FORBIDDEN WITHOUT WRITTEN PERMISSION FROM ARCHITECTURE AND DESIGN.
 Project Number: 16-02A

Date: 9/18/2017
 Author
 Drawn By: Checker
 Checked By: 09/22/17
 Revisions:

REVISION SCHEDULE

#	DESCRIPTION	DATE

Montana Creative
 architecture + design

MONTANA CREATIVE
 ARCHITECTURE + DESIGN
 158 RAILWAY ST.
 WHITEFISH, MT 59937
 406.862.8152

THE CABINS AT WHITEFISH:
 WHITEFISH, MT. 59937

A1.0